



ANCHOR YOUR HOME IN LUXURY

Mariner. An extraordinary waterfront residence with the luxury and ease of living on a yacht. From stunning water views to the city at your doorstep, this is the sophisticated waterfront living you've been waiting for.



ONE BEDROOM

Floors:	Enclosed Area:	Balcony:	Total Area:
3rd to 27th	658 sq.ft.	41 sq.ft.	699 sq.ft.



The developer reserves the right to make modifications and changes to building design, specifications, features, ceiling heights and floor plans without notification. These items may also be subject to change. Suite sizes are compared to the standard floor plan of similar units. The enclosed floor plan is subject to change and is for informational purposes only. The enclosed floor plan is not intended to be used as a legal document. Each unit is located on the developer's plan and is subject to change without notice. All dimensions shown are approximate and are not intended to be used as a legal document. The enclosed floor plan is not intended to be used as a legal document. Each unit is located on the developer's plan and is subject to change without notice. All dimensions shown are approximate and are not intended to be used as a legal document. The enclosed floor plan is not intended to be used as a legal document. Each unit is located on the developer's plan and is subject to change without notice. All dimensions shown are approximate and are not intended to be used as a legal document.

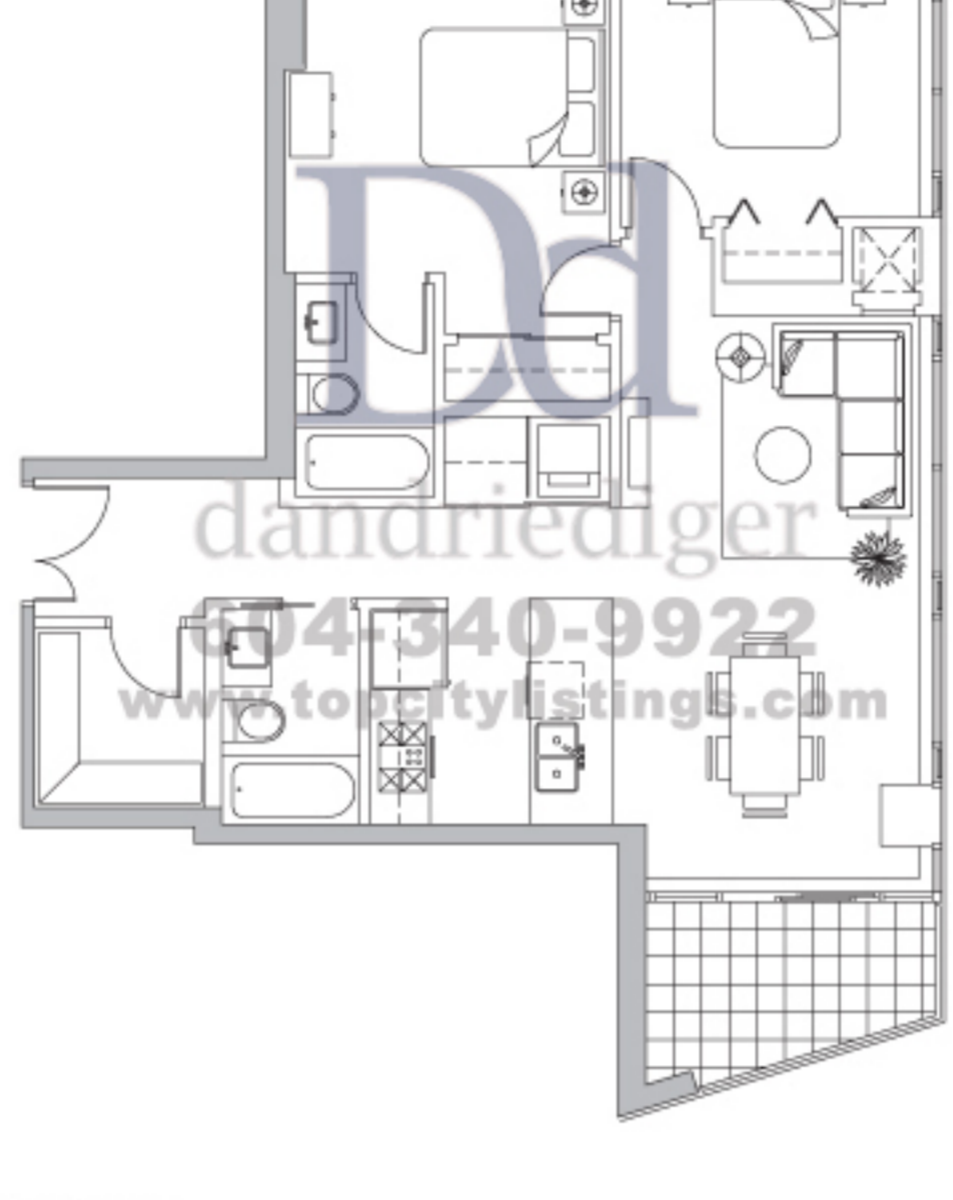

TWO BEDROOM

Floors:	Enclosed Area:	Balcony:	Total Area:
3rd to 27th	923 sq.ft.	65 sq.ft.	988 sq.ft.



The developer reserves the right to make modifications and changes to building design, specifications, features, ceiling heights and floor plans without notification. These items may also be subject to change. Suite sizes are compared to the standard floor plan of similar units. The enclosed floor plan is subject to change and is for informational purposes only. The enclosed floor plan is not intended to be used as a legal document. Each unit is located on the developer's plan and is subject to change without notice. All dimensions shown are approximate and are not intended to be used as a legal document. The enclosed floor plan is not intended to be used as a legal document. Each unit is located on the developer's plan and is subject to change without notice. All dimensions shown are approximate and are not intended to be used as a legal document.

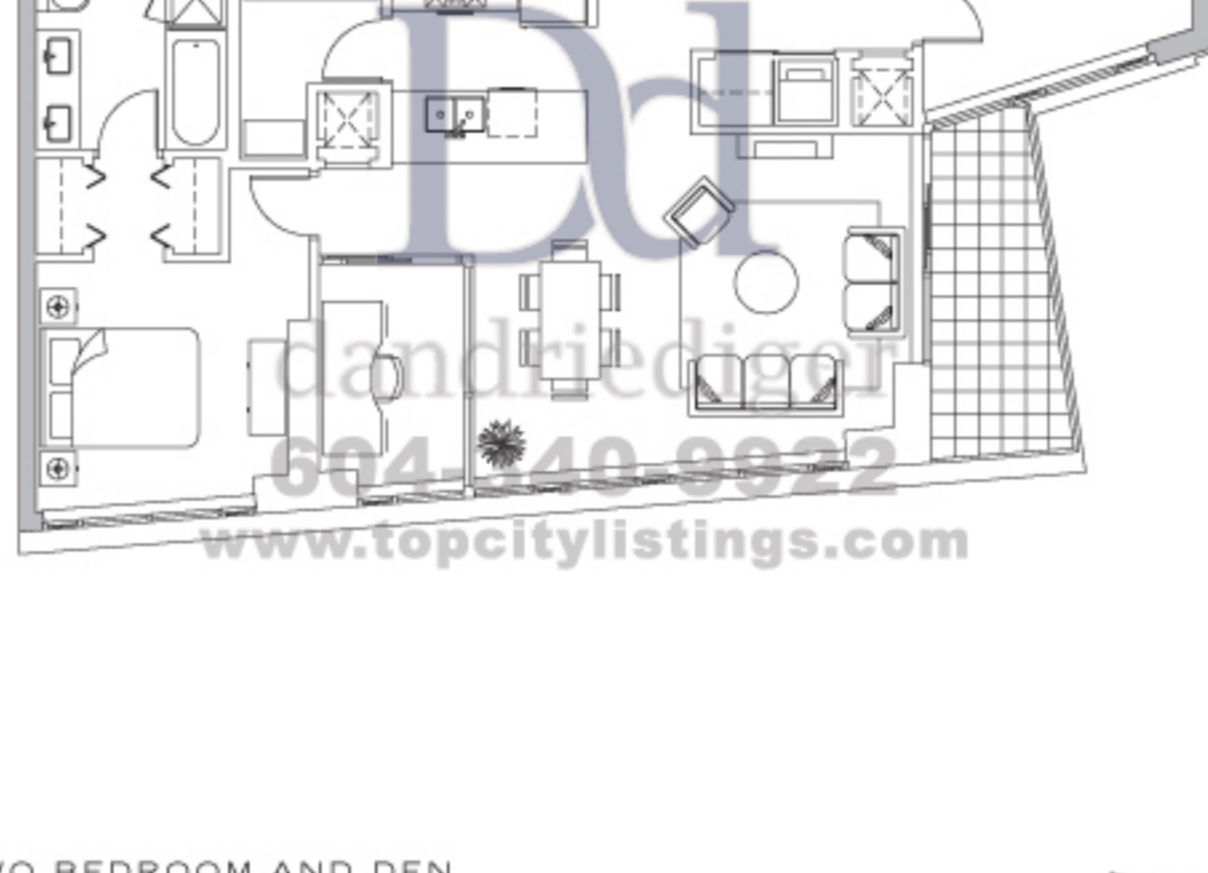

TWO BEDROOM AND DEN

Floors:	Enclosed Area:	Balcony:	Total Area:
5th to 25th	1,123 sq.ft.	79 sq.ft.	1,202 sq.ft.



The developer reserves the right to make modifications and changes to building design, specifications, features, ceiling heights and floor plans without notification. These items may also be subject to change. Suite sizes are compared to the standard floor plan of similar units. The enclosed floor plan is subject to change and is for informational purposes only. The enclosed floor plan is not intended to be used as a legal document. Each unit is located on the developer's plan and is subject to change without notice. All dimensions shown are approximate and are not intended to be used as a legal document. The enclosed floor plan is not intended to be used as a legal document. Each unit is located on the developer's plan and is subject to change without notice. All dimensions shown are approximate and are not intended to be used as a legal document.

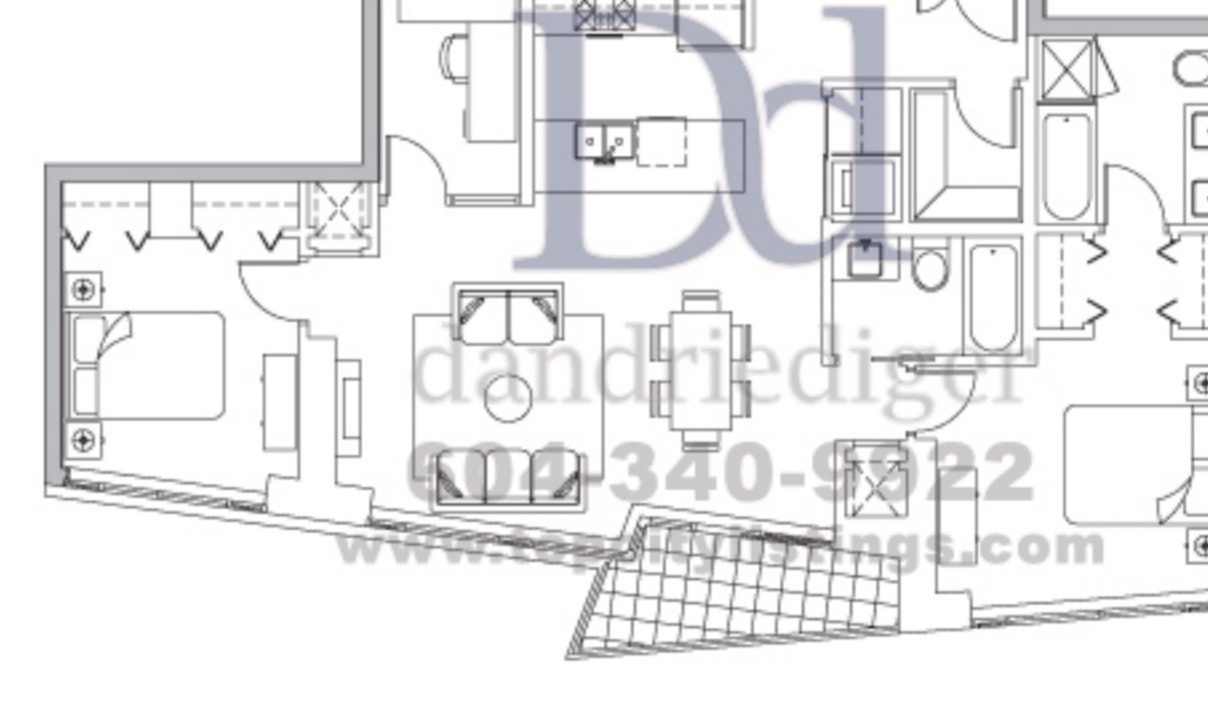

TWO BEDROOM AND DEN

Floors:	Enclosed Area:	Balcony:	Total Area:
5th to 25th	1,093 sq.ft.	59 sq.ft.	1,152 sq.ft.



The developer reserves the right to make modifications and changes to building design, specifications, features, ceiling heights and floor plans without notification. These items may also be subject to change. Suite sizes are compared to the standard floor plan of similar units. The enclosed floor plan is subject to change and is for informational purposes only. The enclosed floor plan is not intended to be used as a legal document. Each unit is located on the developer's plan and is subject to change without notice. All dimensions shown are approximate and are not intended to be used as a legal document. The enclosed floor plan is not intended to be used as a legal document. Each unit is located on the developer's plan and is subject to change without notice. All dimensions shown are approximate and are not intended to be used as a legal document.

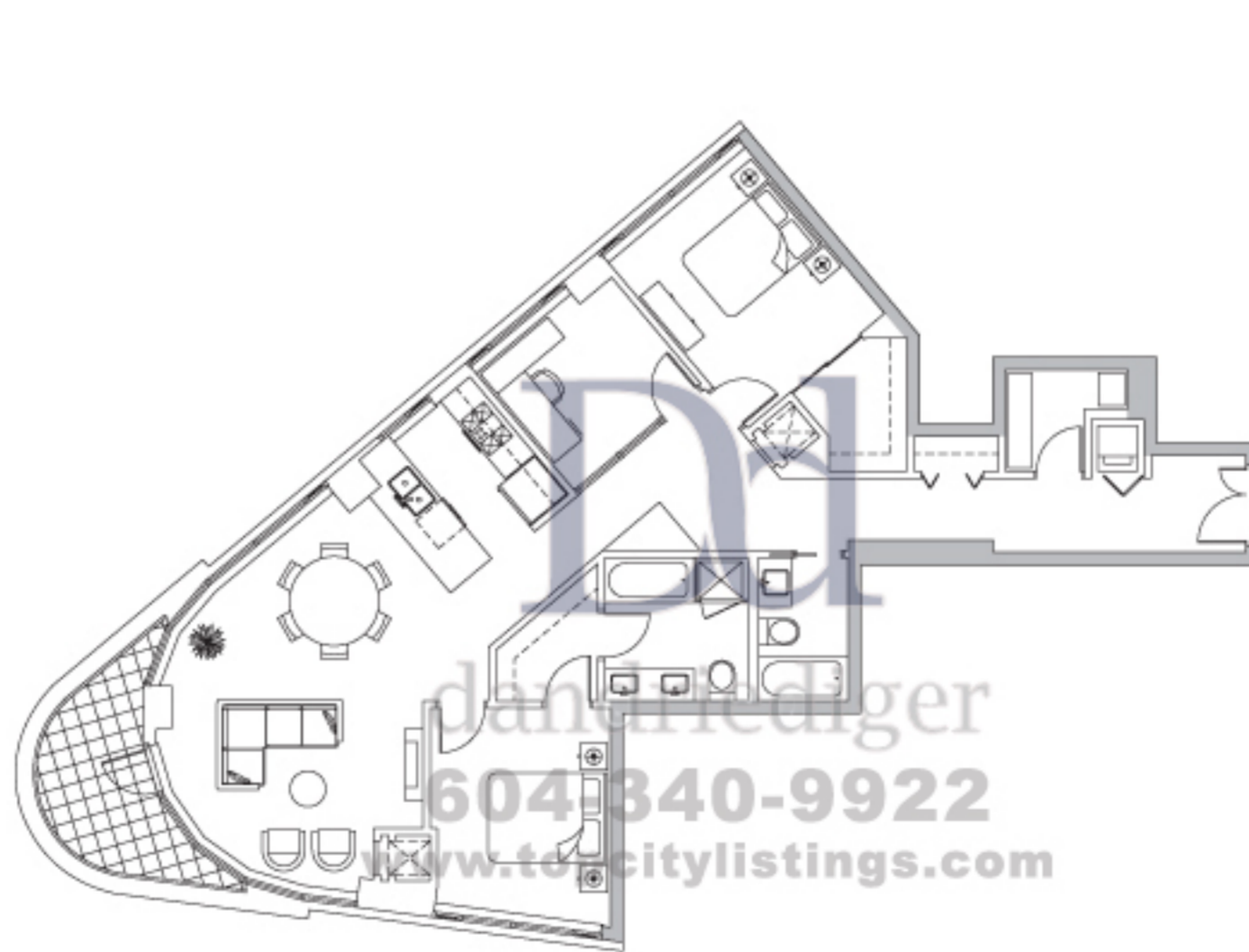

TWO BEDROOM AND DEN

Floors:	Enclosed Area:	Balcony:	Total Area:
5th to 25th	1,273 sq.ft.	81 sq.ft.	1,354 sq.ft.



The developer reserves the right to make modifications and changes to building design, specifications, features, ceiling heights and floor plans without notification. These items may also be subject to change. Suite sizes are compared to the standard floor plan of similar units. The enclosed floor plan is subject to change and is for informational purposes only. The enclosed floor plan is not intended to be used as a legal document. Each unit is located on the developer's plan and is subject to change without notice. All dimensions shown are approximate and are not intended to be used as a legal document. The enclosed floor plan is not intended to be used as a legal document. Each unit is located on the developer's plan and is subject to change without notice. All dimensions shown are approximate and are not intended to be used as a legal document.

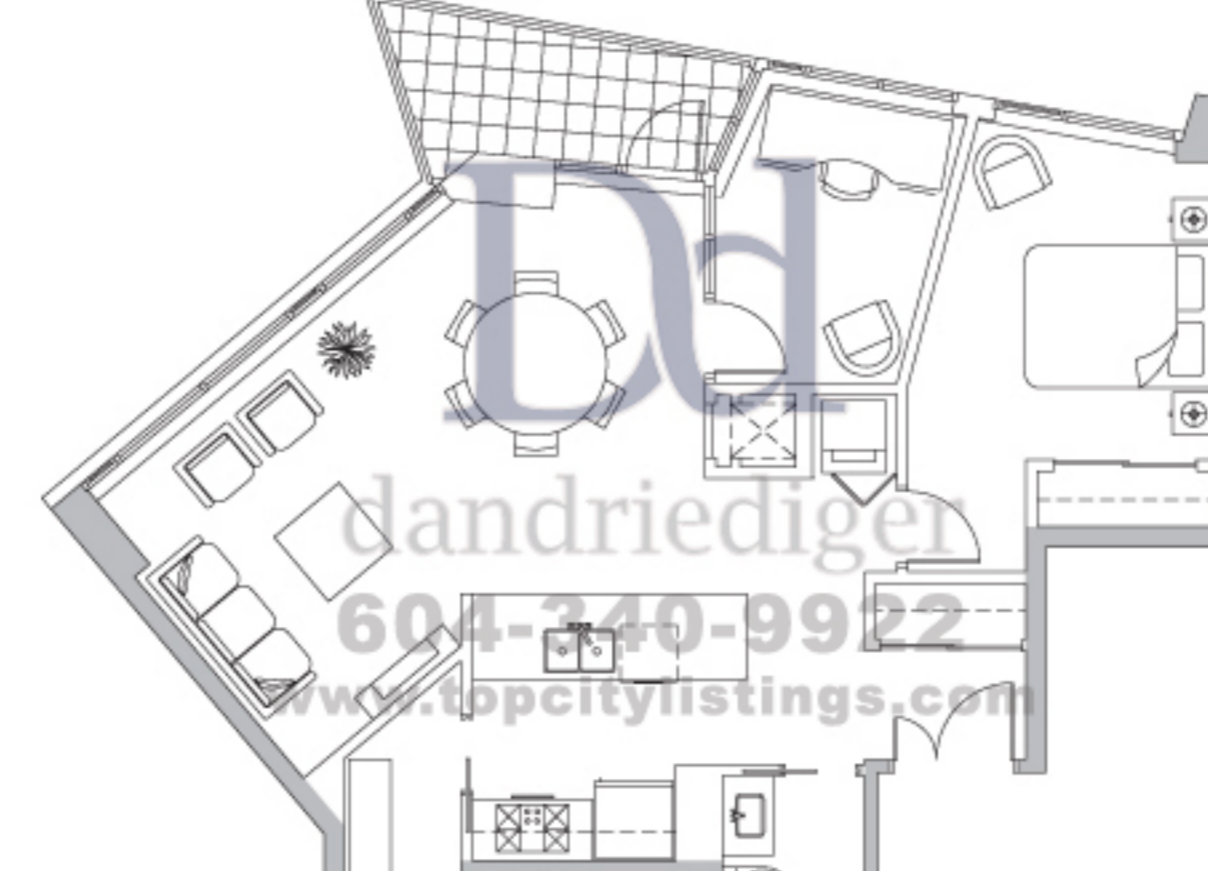

ONE BEDROOM AND DEN

Floors:	Enclosed Area:	Balcony:	Total Area:
5th to 27th	875 sq.ft.	64 sq.ft.	939 sq.ft.



\*07 plan becomes suite 2606 and 2706 on 26th floor and 27th floor.

The developer reserves the right to make modifications and changes to building design, specifications, features, ceiling heights and floor plans without notification. These items may also be subject to change. Suite sizes are compared to the standard floor plan of similar units. The enclosed floor plan is subject to change and is for informational purposes only. The enclosed floor plan is not intended to be used as a legal document. Each unit is located on the developer's plan and is subject to change without notice. All dimensions shown are approximate and are not intended to be used as a legal document. The enclosed floor plan is not intended to be used as a legal document. Each unit is located on the developer's plan and is subject to change without notice. All dimensions shown are approximate and are not intended to be used as a legal document.